

**NOTE:** If adding an installed wall control (CM128) you will need a second person to press and hold the desired button. If not installed, program the wall button into the opener before mounting.

### **ADDING transmitters using the LRN “LEARN” button**

- Press and hold down the button you wish to program to the opener.
- The orange LED will flash to indicate it is receiving signal from the transmitter.
- Press and release the “LRN” button.
- The courtesy LEDs will flash once.
- Ensure the door is clear of obstruction, then test the transmitter.

### **Deleting ALL transmitter codes**

**NOTE:** This deletes all transmitters and codes

- Press and hold the LRN learn button until the orange indicator light goes out (approximately 9 sec).

### **TO ADD Transmitters / Wireless wall button**



or



**Press and hold down the desired Button.**



**LED will FLASH**

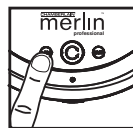

**Press LRN**



**Release LRN button when Courtesy LEDs flashes once**



### **TO DELETE ALL REMOTES**



**Press LRN for 9 seconds**



**LED on WILL TURN ON**

**After 9 seconds all remotes are deleted and LED will go out.**